



AVAILABLE 199,203 SF | DIVISIBLE AND EXPANDABLE

# 1323 Brewster Creek Boulevard

*Bartlett, IL*



- » Available: 199,203 SF (existing)
- » Expandable to: 299,437 SF
- » Divisible to: 98,665 SF
- » Existing building: 421,403 SF
- » Expanded building: 521,588 SF
- » 32' clear
- » Cross-docked
- » 24 dock doors (expandable to 48)
- » 2 drive-in-doors
- » 80 car parking spaces (expandable to 800)
- » 20 trailer parking spaces (expandable to 200)
- » 50' x 50' bay size with 60' speed bays
- » 3,000 amp, 480v power
- » Easy access to I-90, I-390, I-355
- » ESFR
- » T-5 lighting with motion sensors
- » Rupp 80/20 Make-Up Air Unit

# 1323 Brewster Creek Boulevard

Bartlett, IL

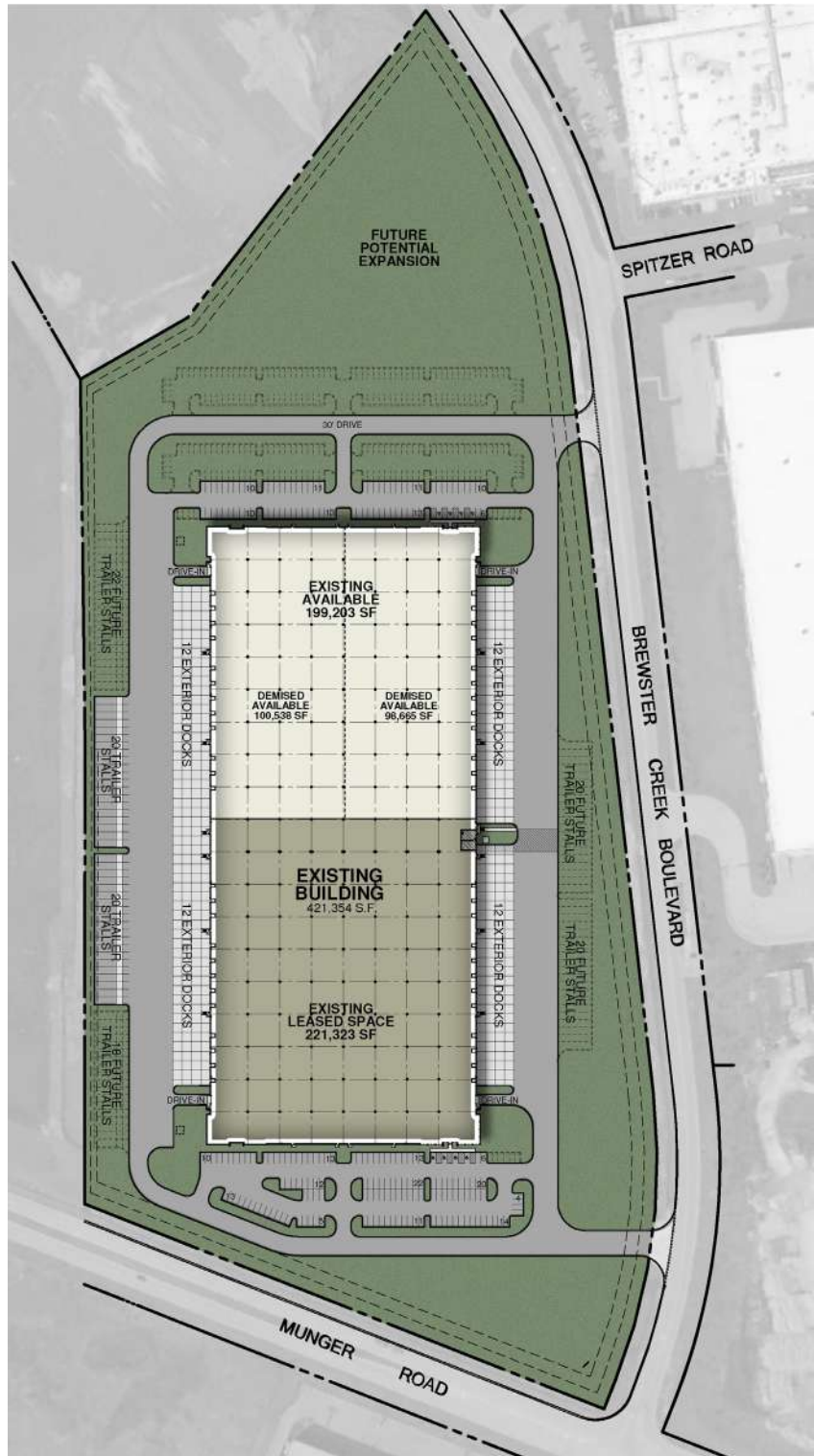

# 1323 Brewster Creek Boulevard

Bartlett, IL

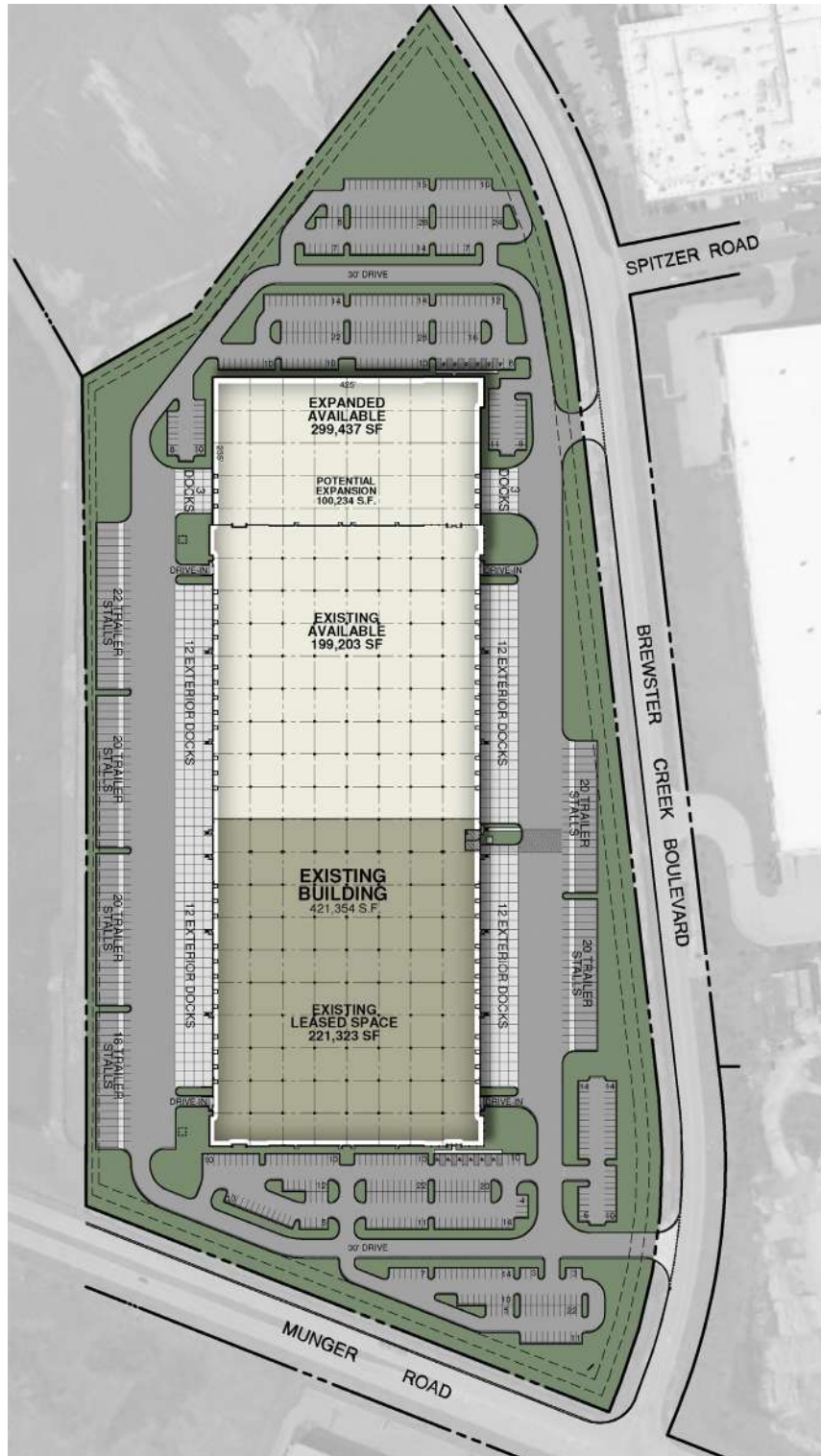

# 1323 Brewster Creek Boulevard

*Bartlett, IL*

