

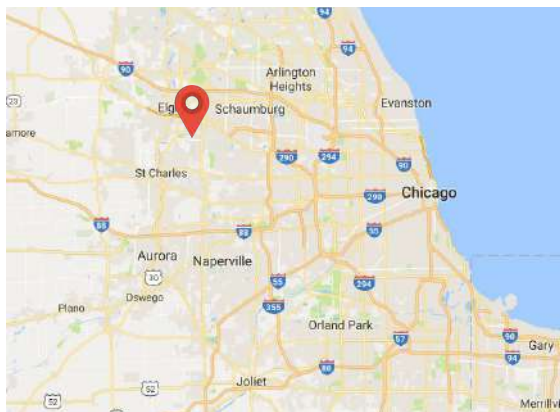

AVAILABLE 199,203 SF | DIVISIBLE AND EXPANDABLE

1323 Brewster Creek Boulevard

Bartlett, IL



- » 199,203 SF available existing
- » Expandable to 299,437 SF
- » Divisible to 98,665 SF
- » 421,403 SF existing building
- » 32' clear
- » Cross-docked
- » 24 dock doors (expandable to 48)
- » 2 drive-in-doors
- » 80 car parking spaces (expandable to 800)
- » 20 trailer parking spaces (expandable to 200)
- » 50' x 50' columns spacing with 60' speed bays
- » 3,000 amp, 480v power
- » Easy access to I-90, I-390, I-355 and O'Hare International Airport
- » ESFR
- » T-5 lighting with motion sensors

1323 Brewster Creek Boulevard

Bartlett, IL

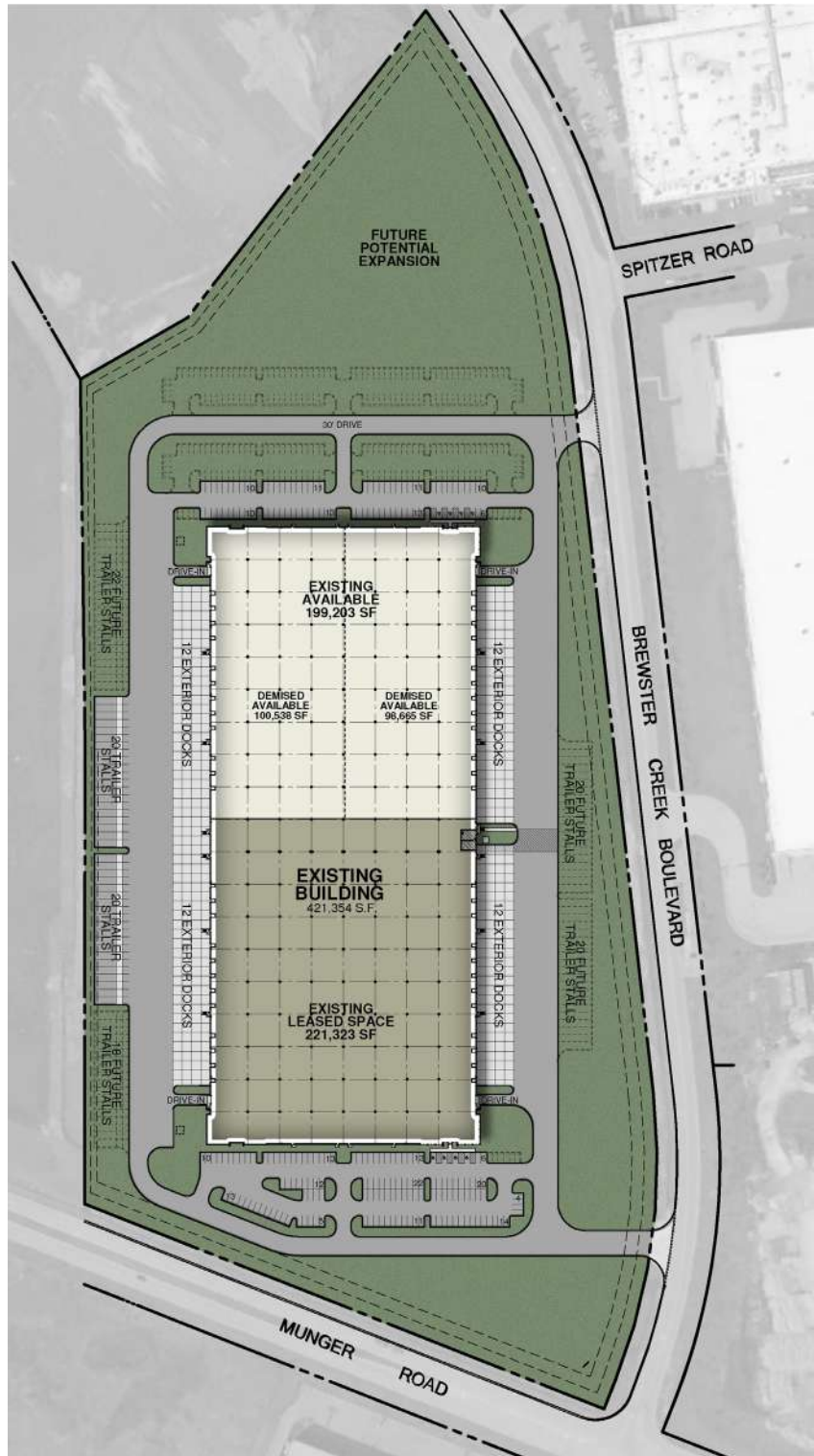

1323 Brewster Creek Boulevard

Bartlett, IL

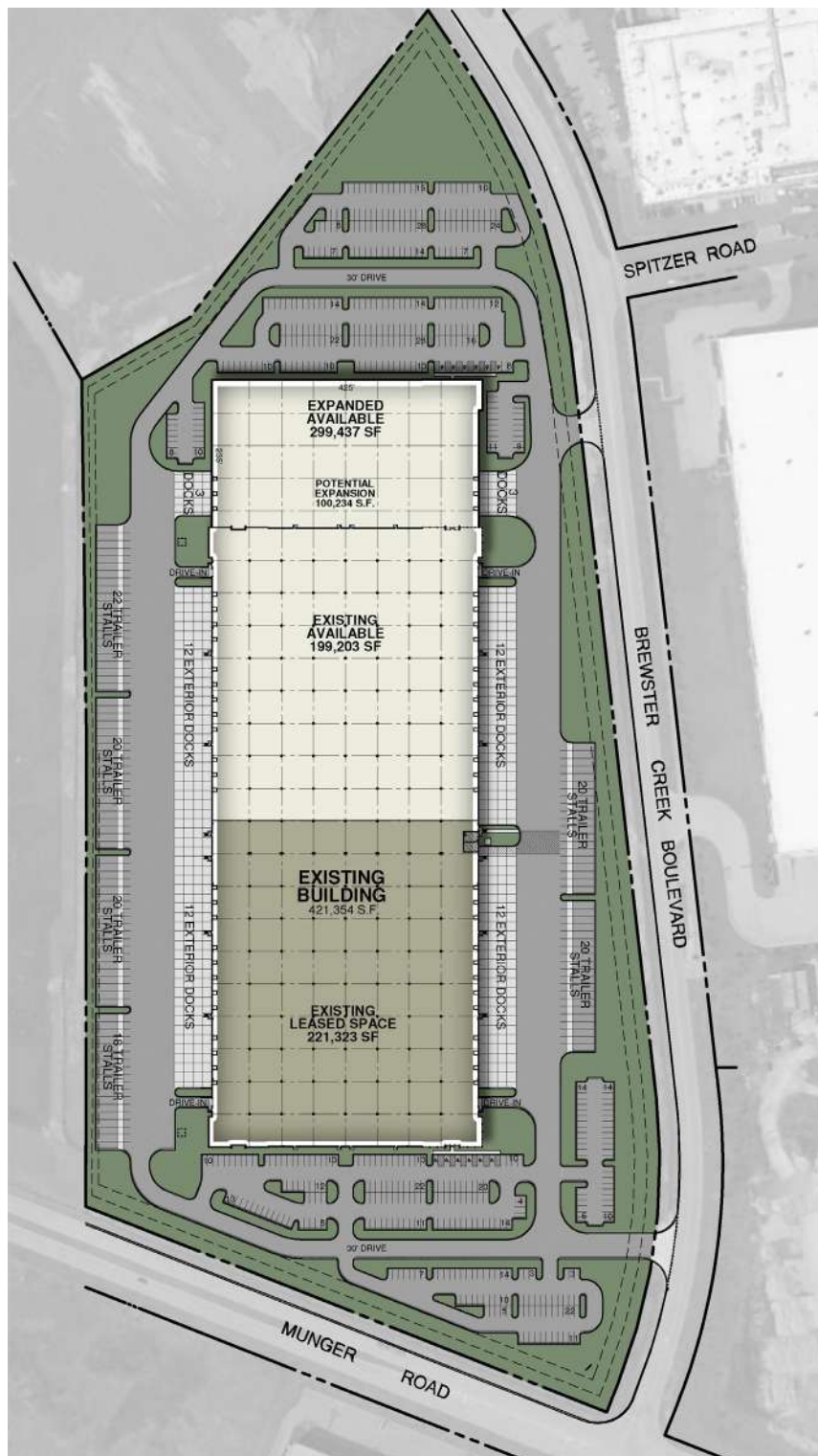

1323 Brewster Creek Boulevard

Bartlett, IL

